

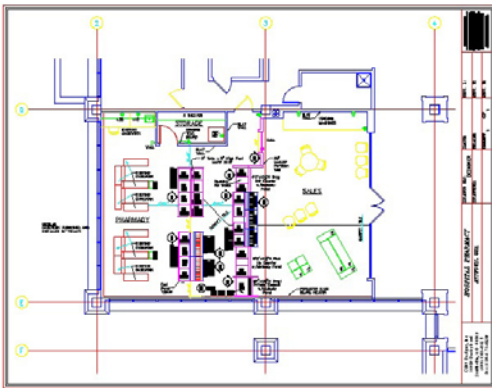

The Design Process



Existing Pharmacy



Design Process



Completed Pharmacy

Customer signs Designs Agreement and mails CURV Designs the required design fee.

CURV Designs consultant travels to site to meet with customer to discuss the objectives of the new design and take accurate field dimensions and photos.

OR

CURV Designs can also be provided with blueprints, electronic CAD drawing, or a sketch of the current facility. The customer will be responsible for verifying dimensions prior to placement of fixture order.

The CURV Designs consultant begins putting a plan in place to create a unique store design that caters to the customer's specific needs.

The consultant sends the customer preliminary design options for consideration.

The customer and the consultant work closely, revising the different design options until the customer approves a design.

The consultant generates and submits detailed plans to the customer and all parties involved. These drawings include a plan view showing fixture placement and elevations.

CURV Designs sends the customer a bid for all casework, countertops, fixtures, etc. CURV Designs will provide a bid for installation if requested.

The customer approves and signs the bid and sends CURV Designs a 50% fixture deposit, which is required before fixtures can be ordered.

CURV Designs will order the fixtures and generate a timeline based on customer and vendor schedules.

CURV Designs will assist in any planning needed to ensure that the project's timeline is maintained.

An appointed representative of CURV Designs, or customer's installer will receive and install all casework, countertops, fixtures, etc. in accordance with the drawings and timelines. CURV Designs will only be responsible for installing the products that we provide.

At the time of fixture shipment, CURV Designs will invoice the 50% balance of fixture cost and any applicable sales tax.

CURV Designs will invoice the customer for installation, and freight if applicable.

An appointed representative of CURV Designs, or customer's installer will conduct a final walk-thru with the customer to ensure that the customer's expectations have been met.

CURV Designs will follow up with customer to ensure the customer's satisfaction.

CURV Designs Inc

14609 Derby Road Smithville, MO 64089-9029

Toll Free: (866) 271-4161 / Phone: (816) 898-0997 / Fax: (816) 873-0209

E-Mail: curvdesigns@sbcglobal.net Web Site: curvdesign.com